

1481 Azalea Rd

MORRISON COUNTY INSPECTION AND ASBUILT

Name Bonnie Flansburg Parcel # 18-D134-D10 Permit # 2016-910

System: ☒ New ☐ Alternate Old system Collapsed: ☐ Yes ☐ No

Tank Size 100/150 Manufacturer BoW Tank Depth 24"  
Pump Tank Size \_\_\_\_\_ Manufacturer \_\_\_\_\_ Tank Depth \_\_\_\_\_

Pump Size 1/2 HP Pump Make Zeolite Alarm Type Zeolite ☐ Pressure Test Required

Type: ☒ I ☐ II ☐ III ☐ IV ☐ V Drainfield = 380 Sq Ft

☐ Trench: Number \_\_\_\_\_ Length \_\_\_\_\_ Width \_\_\_\_\_ ☐ Pressurized Trenches  
Laterals: Size \_\_\_\_\_ Perf Size \_\_\_\_\_ Perf Spacing \_\_\_\_\_ Manifold Size \_\_\_\_\_

☐ Pressure Bed: Bed size L \_\_\_\_\_ x W \_\_\_\_\_ Laterals # \_\_\_\_\_ Size \_\_\_\_\_ Perf Size \_\_\_\_\_ Perf Spacing \_\_\_\_\_ Manifold Size \_\_\_\_\_

☒ Mound: Bed Size L 38 x W 10 Laterals # 3 Size 1 1/2" Perf Size 1/4" Perf Spacing 3' Manifold Size 2"

Inches Rock Below Pipe 8" From Kutze River Inches Sand 18" From Kutze River

Chambers: Manufacturer \_\_\_\_\_ Length Per Section \_\_\_\_\_ Width \_\_\_\_\_ Number of Chambers Total \_\_\_\_\_

Other Media: Manufacturer \_\_\_\_\_ Notes: \_\_\_\_\_

☒ Restrictive Layer Verified to Design 18" ☒ 3 Ft Separation Verified to Design 36" cover 12"

**Measurements**  
Tank to House 43  
P. Tank to House \_\_\_\_\_  
Tank to Well 100'  
P. Tank to Well \_\_\_\_\_  
Tank to Drainfield 77  
P. Tank to Drainfield \_\_\_\_\_  
Tank to Nearest P.L. 100'  
P. Tank to Nearest P.L. \_\_\_\_\_  
Drainfield to House 60  
Drainfield to Well 100'  
Drainfield to P.L. 100'  
Tank to OHWM \_\_\_\_\_  
P. Tank to OHWM \_\_\_\_\_  
Drainfield to OHWM \_\_\_\_\_  
Supply Pipe to Well 50'

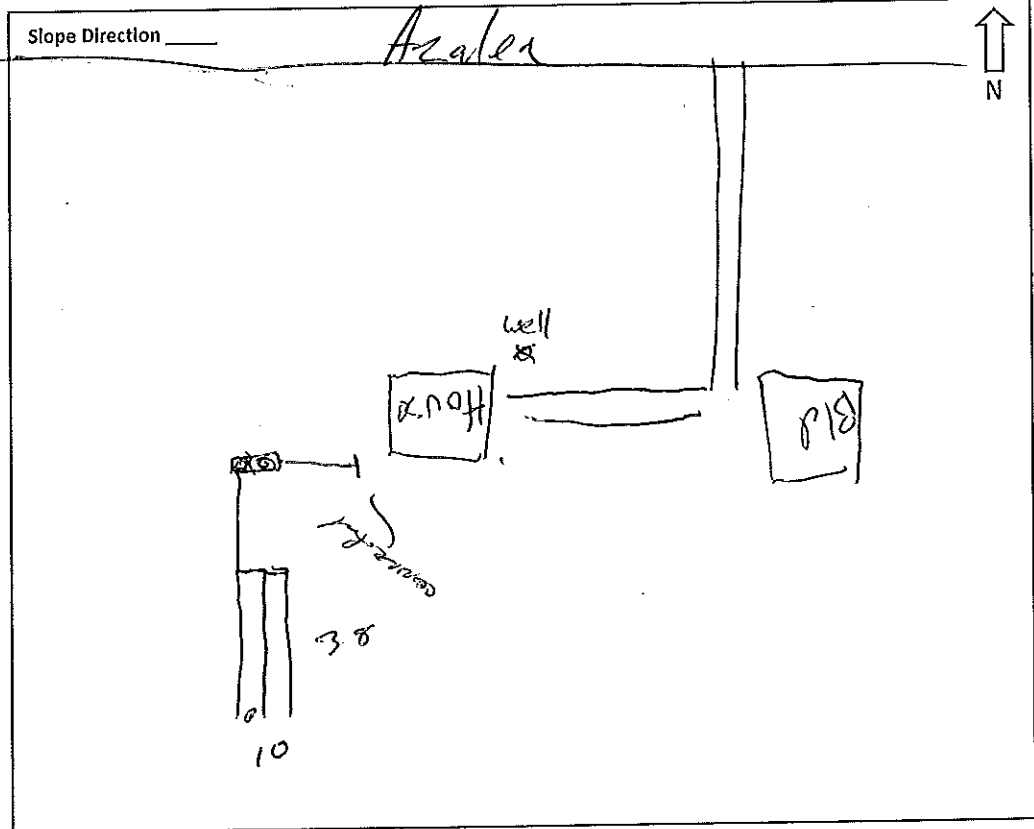

**CERTIFIED STATEMENT**

THIS CERTIFIES: The work done on this system has been completed in accordance with the design submitted with this permit. Morrison County waives all responsibility of future hydraulics because of abuse, water use or maintenance.

[Signature] License # 12831  
Licensed Installer or DRP

Installer Mike Altrichter

Inspector [Signature]

Date of Installation 22 June 16

Certificate of Installation ☒ Yes ☐ No Issue Date 7/13/16

**BROWN-WILBERT TANK INSTALLATION INSTRUCTIONS**

**SITE CONDITIONS**

The site must be accessible to large heavy trucks. Be free of items like trees, stumps, overhead wires and buildings that could interfere with delivery or installation. The trucks must be able to within three to six feet of placement excavation.

**EXCAVATION**

Excavation should be approximately 12" minimum larger than tank size to allow for adequate back fill; this may vary with soil conditions. Excavation shall have a level bottom so the weight bears on the outside walls of the tank.

**BEDDING**

Proper use of bedding materials is important to ensure service life of the tank structure. Bedding must be capable of bearing the weight of the tank. Bedding material shall have the ability of 100% to be able to pass through a 1/4" screen. Bedding thickness shall be 4" minimum compacted (thickness may vary with existing soil conditions).

**JOINT SEAL**

Joint surfaces must be clean and proper placement of sealant according to manufactures recommendations.

**WATER TABLE**

Tanks being placed where water levels can potentially be higher than the elevation of the tank cover must be brought to the attention of Brown-Wilbert, Inc. Either an alternate location should be considered or a waterproof coating applied to tank.

**BACKFILL MATERIAL**

Sidewalls of tanks require dry backfill materials that have the ability of 100% to be able to pass through a 2" screen and have a minimum of 12" on all sides from bottom to top of tank. Backfill material shall be placed in a manner to avoid impact loads on the sidewall of tank.

**COVER MATERIAL**

Cover material shall be dry soil, sand or gravel and have the ability of 100% to be able to pass through a 4" screen. Cover material shall be mounded over tank and around risers to direct run-off away from both.

**INLET & OUTLET**

Pipe not to exceed 1" past interior wall of tank where a baffle is used.

**BURIAL DEPTH**

Tanks not to exceed the maximum burial depth of each model's specifications.

Model #:	<u>1500 2C</u>	Liquid Capacity:	<u>1005/504</u>	Max. Burial Depth:	<u>7 FT</u>
Model #:	<u>1000 BT</u>	Liquid Capacity:	<u>1001</u>	Max. Burial Depth:	<u>8 FT</u>
Model #:	_____	Liquid Capacity:	_____	Max. Burial Depth:	_____

**FINAL INSPECTION**

☒ Passed

☐ Failed

Customer: Altrichter Sand & Gravel Date & Time to Deliver: 6/21/2016 1:00

<b>Delivery Address:</b> 1480 AZALEA MOTLEY  <b>Directions:</b> HWY 10 RIGHT ON CO RD 28/AZALEA STREET 3/4 MILE	<b>Tanks</b>		
	<u>Qty Sent</u>	<u>Item</u>	<u>Returned Qty</u>
	1	1500 2C	0
	1	1000 BT	0
	<b>All other Supplies</b>		
	<u>Qty Sent</u>	<u>SUPPLIES</u>	<u>Returned Qty</u>
	1	20151-8 BT 1005	0
	2001	Black Riser	0
	1	10-14014	0

Received By: \_\_\_\_\_

Date: 6-21-16

Driver: Pat

\*\*\*Hole Condition as noted by Driver:

Sandy level